

Fig.1/Abb.1

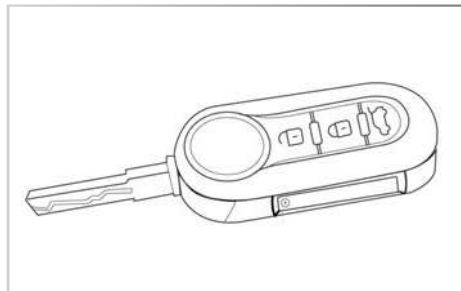

Fig.2/Abb.2

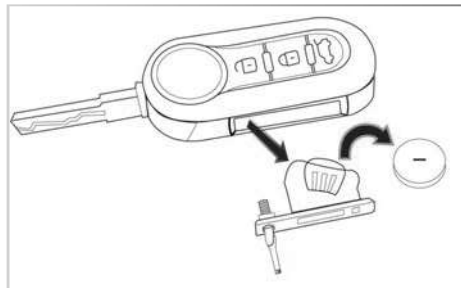

Fig.3/Abb.3

EN CONFIGURING THE REMOTE

SIP22R34 can be set to work in two different modes:

- Mode 1: Compatible with Delphi systems
- Mode 2: Compatible with Marelli systems

HOW TO CHANGE THE OPERATING MODE:

The SIP22R34 remote is supplied configured in Mode 1.

Changing mode:

1. Simultaneously press buttons 1 and 2 (fig. 1) for 6 seconds
2. Release button 2 keeping button 1 pressed
3. Press button 2
 - three times to set mode 1
 - four times to set mode 2.

Note: Every time the mode is changed the remote is reset so that in the case of an error, or an incompatibility it can be re-programmed for the same or other vehicles.

REPLACING THE BATTERY (1 x CR2032)

Follow the instructions in Fig. 3.